

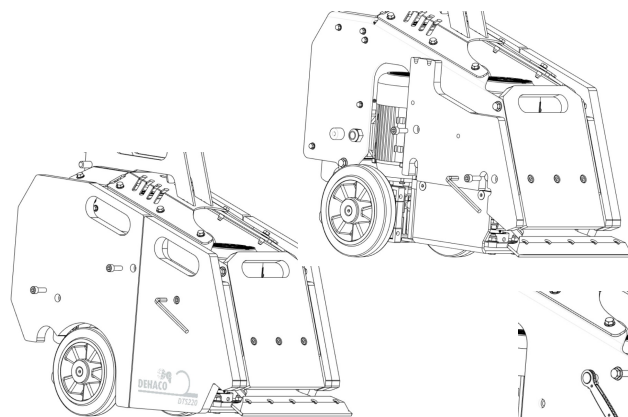

DTS



Set-up

- Unpack and check all parts
- Position and fasten the ballast weights
- Unfold and fasten the handle
- Connect the power cable

1

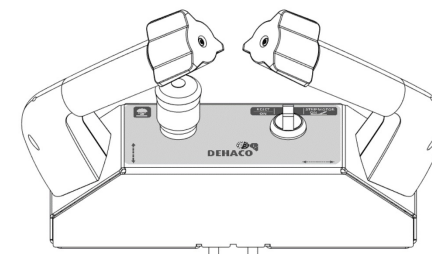

Controls

- Rotate the green handle to drive the DTS220 forwards and backwards
- Adjust the rotation of the orange handle to control the drive speed
- Rotate the orange handle to steer the DTS220, rotate clockwise to turn left and anticlockwise to turn right
- Reset the DTS 220 and turn the stripping mechanism on and off using the switch

2

Blade installation

- Loosen the bolts
- Lift the blade fastener
- Insert the blade, aligning the slots
- Fasten each bolt
- V-blade – cuts and lifts the surface in strips, suitable for vinyl and carpet
- U-blade – cuts the surface into strips, suitable for vinyl
- Flat blade – universal blade, suitable for all surfaces
- Flat blade with bend – blade for tough situations, only suitable for hard underfloor surfaces

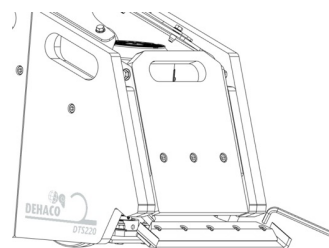
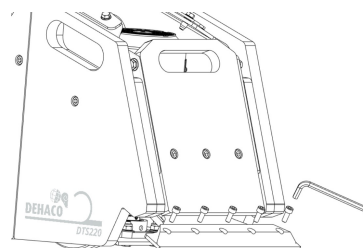

3

Maintenance

- Lubricate all 3 bearings in the stripping mechanism
- Remove any debris from within the stripping mechanism
- Remove any debris from in between the ballast weights
- Hand clean with a damp cloth, do not use a water hose or steam cleaner
- Replace the wheels as required to ensure good traction

4

Safety first

- Always wear your PPE
- Check the area for hazards before working
- Inspect and replace any damaged parts
- Do not touch any moving parts
- Remove the blade during transport

Quick tips

- Work efficiently, create long strips
- Reduce tyre wear by preventing wheelspin
- Use the correct type of blade
- Use the free wheels for quick manoeuvring
- Regularly remove any debris from the stripping mechanism and around the motors
- In case of drive motor failure, remove extension cable and use a different power source

DTS

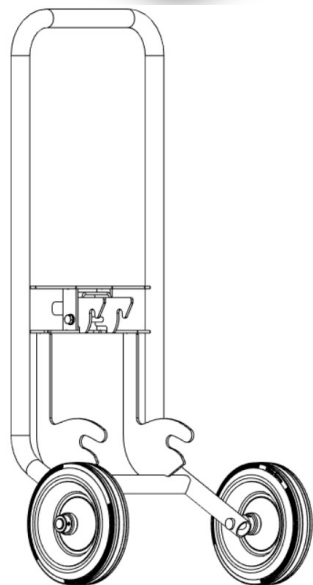

Using the transporter

- Fold the DTS220 handle in and position the transporter behind the floor stripper
- Align the slots on the transporter with the DTS220
- Rotate the transporter forward
- Secure the transporter by pushing the hook into position
- Rotate the transporter and DTS220 until it is in balance on the wheels. The floor stripper is now ready for transport
- Push against the transport and release the handle to remove the transporter, carefully rotate the transporter until the DTS220 wheels are on the floor

